

CSPA Hazelwood Central Percussion Regional Show  
February 29th, 2020  
Hazelwood Central High School – Florissant, Missouri

Dear Directors,

Hazelwood Central High School Band Boosters and CSPA would like to welcome you to the Hazelwood Central High School Percussion Regional Show. We look forward to having you and your members with us on this day. Listed below is the information needed as you finalize your plans for this event. Should your group have special requirements, please contact: [mthomas@hazelwoodschoools.org](mailto:mthomas@hazelwoodschoools.org).

### **LOCATION OF CONTEST:**

Hazelwood Central High School  
15875 New Halls Ferry Road  
Florissant, MO 63031

### **DATE AND TIME OF CONTEST:**

February 29<sup>th</sup>, 2020 Clinics begin at 11:30a Performances begin at 5p Percussion Captain's Retreat estimated start time 7:25p

### **SCHEDULE:**

A current schedule may be accessed through [www.cs-pa.org](http://www.cs-pa.org)

### **ADMISSION PRICES:**

All Day - \$10.00 Adults, \$7 Students /Seniors and Children under 12 years old.

### **EMERGENCY CELL PHONE:**

Mark A. Thomas, Director of Bands – Hazelwood Central High School (314) 269 - 3866; Hazelwood Central High School Band Room 314 653-3706 Robert Gatewood, CSPA Representative, (262)-309-7044

### **PERFORMANCE AREA:**

Groups will enter and exit from the front left of the performance gym. Please ensure that your equipment rolls front-to-back as you exit to ensure the next group as enough room to setup in a timely manner

### **UNIT CHECK-IN:**

Be prepared to declare the number of marching members. Penalties will be assessed for false declarations. Marching members, seven (7) staff plus the director will be admitted at no charge. PLUS PASS WILL BE AVAILABLE, SEVEN (7) ADDITIONAL TICKETS FOR \$40. MONEY TO BE PAID DIRECTLY TO HAZELWOOD CENTRAL. Directors are expected to take care of their bus drivers, staff, etc. with the seven comp tickets as no extra passes will be provided for these individuals. Units are being allowed to store their equipment starting at 9:00 am. Units must officially check-in 90 minutes prior to performance time.

## **DRESSING FACILITIES:**

Available onsite however, space is very limited. Units will be directed to these areas at check in.

## **INSTRUMENT STORAGE:**

We will utilize the Hazelwood Central Commons cafeteria as a place for the units to store all of their personnel equipment. Each unit will have an assigned place in the cafeteria. Please do not leave valuable items in the dressing areas, or with equipment storage. CSPA or Hazelwood Central High School is not responsible for lost or stolen items.

## **UNLOADING OF PROPS AND EQUIPMENT:**

Both will be unloaded in the horseshoe drop-off area in front of the high school. After unloading the equipment, drivers will be directed to the back parking of the school, where another student will direct the drivers to the Director/Driver Hospitality Room (C104).

CSPA asks that no percussion equipment is unloaded until 9:00 am. The doors will be open at 10:45 am for spectators

## **UNLOADING OF PERFORMERS:**

Buses may unload performers north of the equipment unloading. There will be a Hazelwood Student Guide to direct you to Unit Check-In . Buses will be directed to the back parking of the school, where another student will direct the drivers to the Director/Driver Hospitality Room (C104).

## **SPECTATOR PARKING:**

Spectators may park in the lot directly across from the Hazelwood Central Field House.

## **TABULATING AND JUDGING AREA:**

These areas are off limits to everyone except authorized personnel.

## **INTERVAL/TIMING LINE:**

Horizontal Timing Line

## **WARM-UP AREA:**

Percussion warm-ups will be in the Commons Area (A) and also in the Wrestling Room (B). Electricity will be provided in both areas

## **EQUIPMENT/PROPS:**

You may store your equipment and props in your area until the conclusion of show, at that time you may load-out.

## **TARP FOLDING:**

There will be a "Tarp Crew" to assist you with the removal of your tarp and other equipment at your request. The tarp re-folding area will be in the Small Gym.

## **JUDGE'S COMMENTS:**

Judge's comments may be acquired by registering on Competition Suite website, [www.competitionsuite.com](http://www.competitionsuite.com),

## **CRITIQUE:**

There will be no critique provided at this show

## **RETREAT:**

Retreat is expected to start at 7:25p, however please be flexible as this is our first show of the year.

## **VIDEO TAPING:**

CSPA will not be actively monitoring individuals videotaping, however the circuit is not responsible for any copyright infringement. Groups are responsible for monitoring this themselves.

## **ADJUDICATORS:**

Levi Chavis, David Pickett, Bret Kuhn, Michael McIntosh

## **A NOTE REGARDING SAFETY OF STUDENTS:**

We ask all directors to have a conversation with your students about common sense and good judgment, and personal safety on the day of the festival. PLEASE ask your students to not wander from the festival area. Discussion with your students about this matter will be greatly appreciated.

## **CONCESSIONS:**

There will be concessions available just outside of the gymnasium. You are not allowed to take food and drink into the gymnasium.

**OUTSIDEFOOD WILL NOT BE PERMITTED INTO THE BUILDING. CSPA ASKS THAT YOU SUPPORT OUR HOSTS BY VISITING THEIR CONCESSIONS.**

Thank you for your attendance today and we hope everyone has great performances and an enjoyable day.

Mark A. Thomas  
Director of Bands Hazelwood Central High School

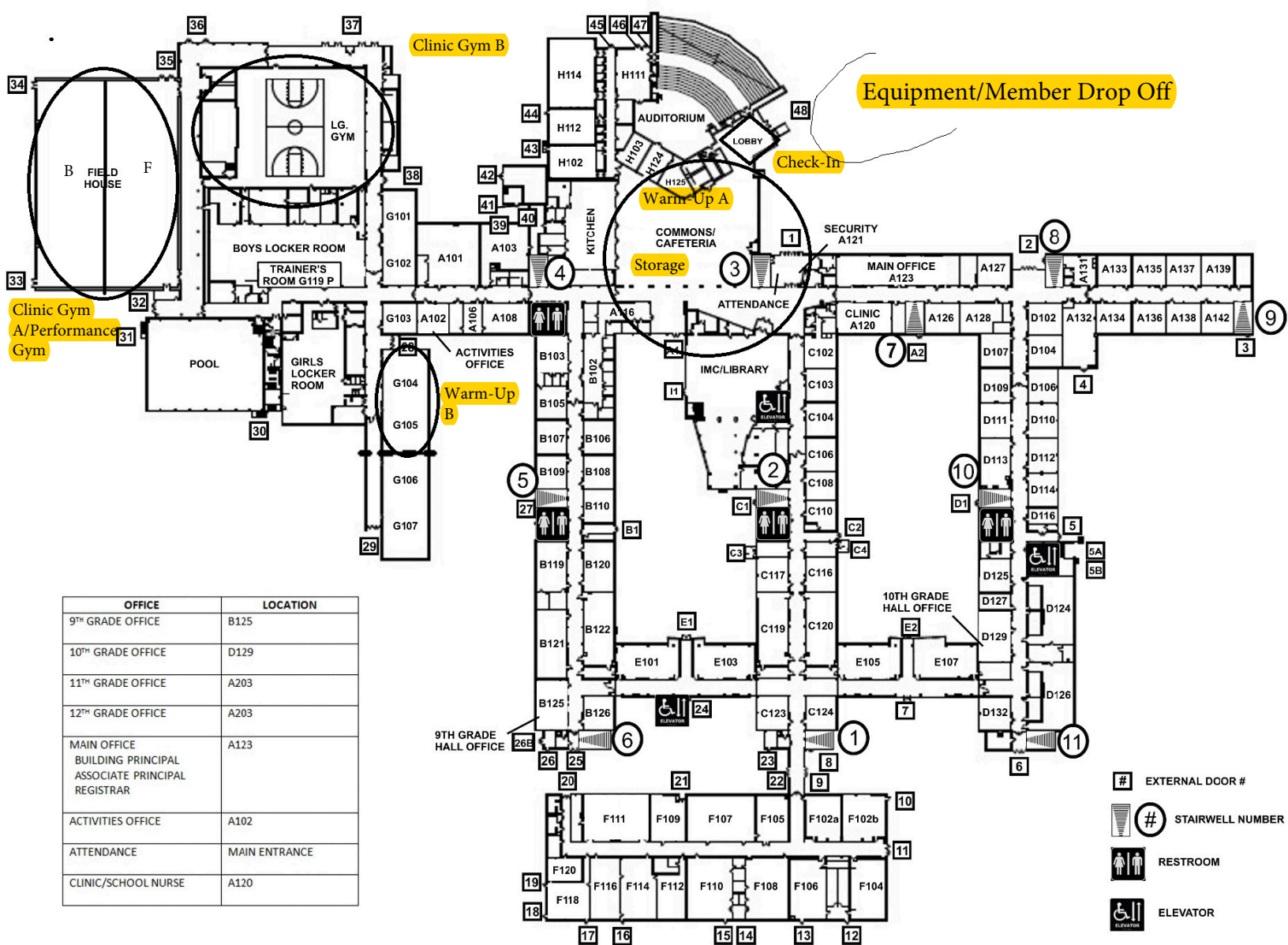

Clinic Gym B

Equipment/Member Drop Off

Clinic Gym A/Performance Gym

Warm-Up A

Storage

Warm-Up B

OFFICE	LOCATION
9 <sup>TH</sup> GRADE OFFICE	B125
10 <sup>TH</sup> GRADE OFFICE	D129
11 <sup>TH</sup> GRADE OFFICE	A203
12 <sup>TH</sup> GRADE OFFICE	A203
MAIN OFFICE BUILDING PRINCIPAL ASSOCIATE PRINCIPAL REGISTRAR	A123
ACTIVITIES OFFICE	A102
ATTENDANCE	MAIN ENTRANCE
CLINIC/SCHOOL NURSE	A120

# EXTERNAL DOOR #

# STAIRWELL NUMBER

RESTROOM

ELEVATOR

CENTRAL STATES PERCUSSION ASSOCIATION

HAZELWOOD CENTRAL - FEB. 29TH, 2020

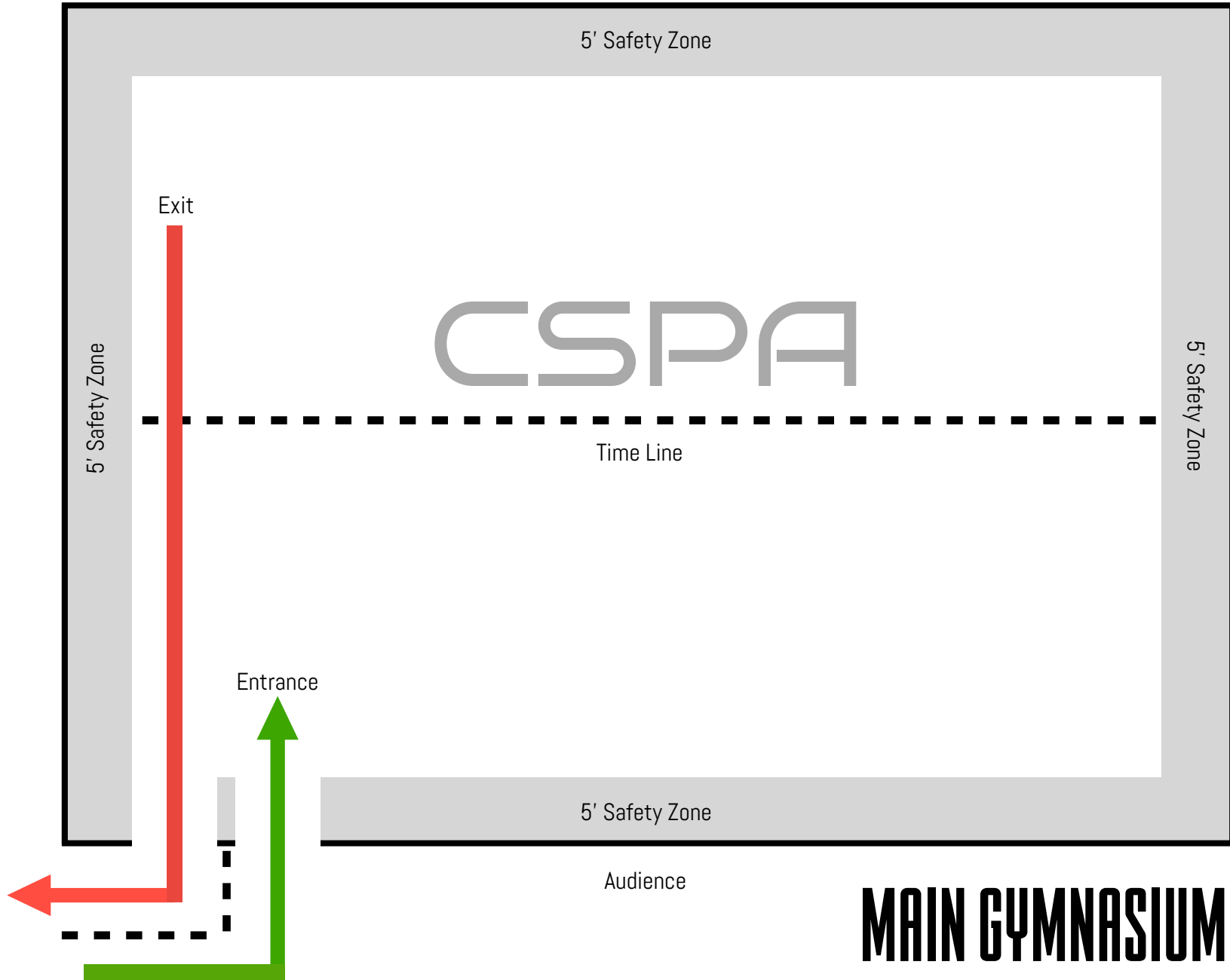

CENTRAL STATES PERCUSSION ASSOCIATION

HAZELWOOD CENTRAL - FEB. 29TH, 2020

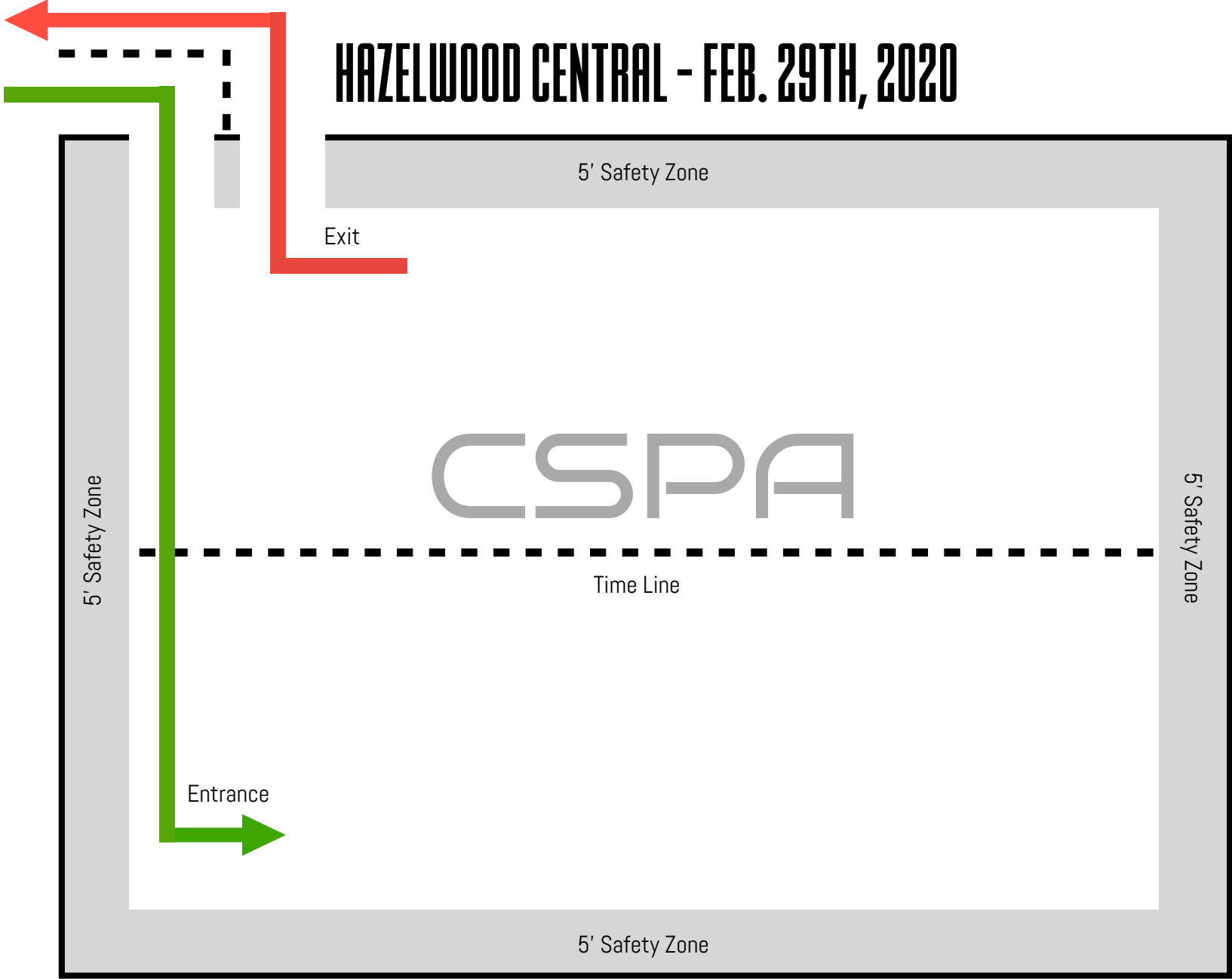

5' Safety Zone

Exit

CSPA

Time Line

Entrance

5' Safety Zone

5' Safety Zone

5' Safety Zone

Audience

AUX GYMNASIUM



## CLINIC SCHEDULE - HAZELWOOD CENTRAL HIGH SCHOOL - FEB. 29TH 2020

UNIT	CLASSIFICATION	CHECK IN BY	PROPS/EQUIPMENT IN	WARM-UP	AREA	TRAVEL	UNIT REPORT	MOVE-IN	CLINIC	GYM	DEPARTURE
Wright City HS	Scholastic Concert A	10:00a	10:00a	10:50a	B	11:15a	11:20a	11:27a	11:30a	B	11:58a
Murphysboro HS	Scholastic A	10:30a	10:30a	11:20a	B	11:45a	11:50a	11:57a	12:00p	A	12:28p
Hazelwood Central	Scholastic A	10:30a	10:30a	11:20a	A	11:45a	11:50a	11:57a	12:00p	B	12:28p
Mascoutah HS	Scholastic A	11:00a	11:00a	11:50a	B	12:15p	12:20p	12:27p	12:30p	A	12:58p
Mater Dei HS	Scholastic A	11:00a	11:00a	11:50a	A	12:15p	12:20p	12:27p	12:30p	B	12:58p
Modulation Z	Independent A	11:30a	11:30a	12:20p	B	12:45p	12:50p	12:57p	1:00p	A	1:28p
Washington HS	Scholastic A	11:30a	11:30a	12:20p	A	12:45p	12:50p	12:57p	1:00p	B	1:28p
BREAK											
Freedom Percussion	Independent World	12:30p	12:30p	1:20p	A	1:45p	1:50p	1:57p	2:00p	A	2:28p
Francis Howell HS	Scholastic Open	12:30p	12:30p	1:20p	B	1:45p	1:50p	1:57p	2:00p	B	2:28p
Lee's Summit HS	Scholastic A	1:00p	1:00p	1:50p	A	2:15p	2:20p	2:27p	2:30p	A	2:58p
Odessa HS	Scholastic A	1:00p	1:00p	1:50p	B	2:15p	2:20p	2:27p	2:30p	B	2:58p

30 minute clinics from timeline to timeline



## PERFORMANCE SCHEDULE - HAZELWOOD CENTRAL HIGH SCHOOL - FEB. 29TH 2020

<u>UNIT</u>	<u>CLASSIFICATION</u>	<u>WARM-UP</u>	<u>AREA</u>	<u>TRAVEL</u>	<u>UNIT REPORT</u>	<u>PERFORM</u>
Mascoutah HS	Scholastic A	4:29p	A	4:47p	4:52p	5:00p
Odessa HS	Scholastic A	4:37p	B	4:55p	5:00p	5:09p
Hazelwood Central HS	Scholastic A	4:47p	A	5:05p	5:09p	5:18p
Mater Dei HS	Scholastic A	4:55p	B	5:13p	5:18p	5:27p
Washington HS	Scholastic A	5:05p	A	5:23p	5:27p	5:36p
Lee's Summit HS	Scholastic A	5:13p	B	5:31p	5:36p	5:45p
Murphysboro HS	Scholastic A	5:23p	A	5:41p	5:45p	5:54p
Wright City HS	Scholstic Concert A	5:31p	B	5:49p	5:54p	6:03p
Break						
Modulation Z	Independent A	6:03p	A	6:21p	6:26p	6:35p
Francis Howell HS	Scholastic Open	6:11p	B	6:29p	6:34p	6:44p
Freedom Percussion	Independent World	6:21p	A	6:39p	6:44p	6:54p